



AQUATEX ESWP pumps are light duty sewage pumps driven by high performance dry type submersible induction motors.

APPLICATIONS

- Transferring domestic sewage and sewage with less solids from collection tank to primary settling tank.



FEATURES

- Dry type submersible induction motor.
- Class 'F' motor insulation.
- Stainless steel shaft and fasteners to enhance life.
- Chemical resistant coating on impeller and casing to improve life and performance.

Non-Clogging

Large channel casing and single vane impeller allow large floating solids to pass through. Can handle solids up to 40 mm in size.

Thermal Overload Protection

Built-in miniature thermal overload protector prevents the motor coil from burning-out due to high-temperature in single phase models.

Cable Sealing

Resin filled cable connectors prevent water from entering the motor through the cable wire.

Enhanced Motor Life

Dual silicon carbide mechanical seals prevent water from entering the oil chamber from the pump as well as the dry motor from the oil chamber.

PRODUCT DATA

- Power range : 0.5HP to 1.5HP, Single Phase, 220V, 50Hz
- Power range : 0.5HP to 3HP, Three Phase 380V, 50Hz
- Head range : Upto 20m
- Discharge range : Upto 48m³/hr
- Solid handling size : 15mm to 40mm
- Delivery size : 25mm to 65mm

PRODUCT IDENTIFICATION

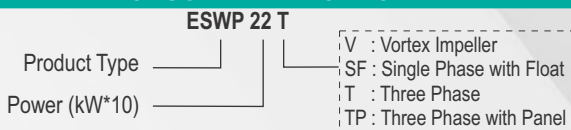

PERFORMANCE CURVE

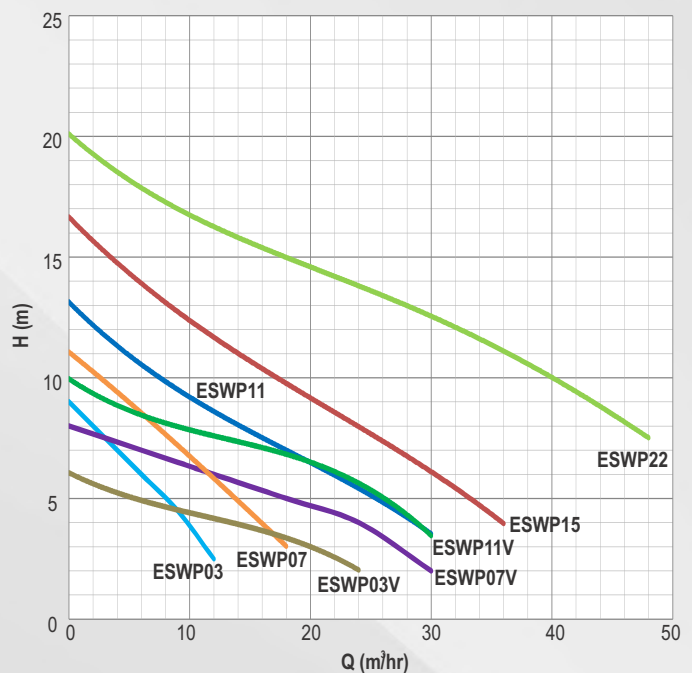

ESWP Series

Submersible Sewage Pumps



MATERIALS OF CONSTRUCTION

ESWP03 / ESWP07 / ESWP11

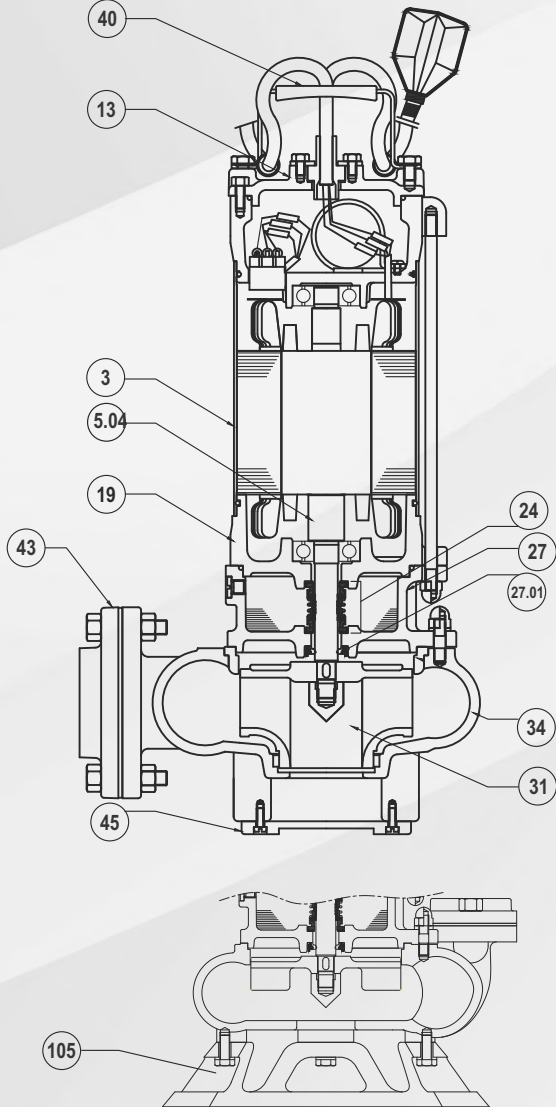

Part No.	Component	Material
3	Stator Body	SS, AISI 304
5.04	Motor Shaft	SS, AISI 410
13	Cable Cover	CI, FG 200
19	Bearing Housing	CI, FG 200
24	Mechanical Seal	Silicon vs Silicon ----- Carbon vs Ceramic
27	Oil Chamber	CI, FG 200
27.01	Lip Seal	SS + Nitrile Rubber
31	Impeller	CI, FG 200
34	Casing	CI, FG 200
40	Handle	SS + Nitrile Rubber
43	Delivery Flange	CI, FG 200
45	Casing Plate	CI, FG 200

ESWP V models

Part No.	Component	Material
105	Inlet Bracket	CI, FG 200

DIMENSIONS AND WEIGHT

Pump Type	Power		Phase	Dimensions (in mm)			Solid Handling Size mm	Weight kg
	HP	kW		A	B	øD		
ESWP03	0.5	0.37	Single / Three	470	235	25	15	25.8
ESWP07	1.0	0.75	Single / Three	460	255	40	20	29.5
ESWP11	1.5	1.1	Single / Three	525	281	50	25	32.5
ESWP15	2.0	1.5	Three	565	306	50	30	50
ESWP22	3.0	2.2	Three	620	347	65	40	50

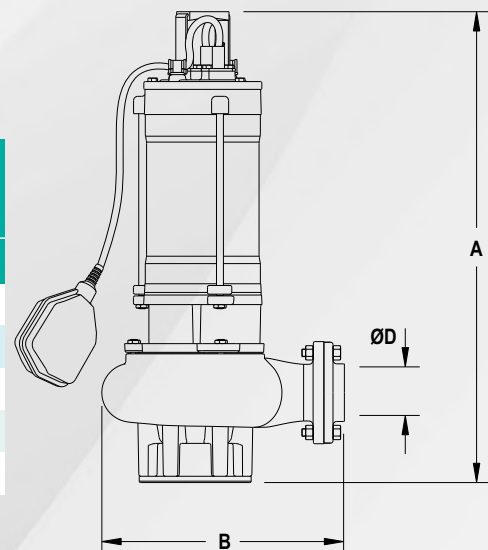

Delivery size available in 50mm (2") on request.

MATERIALS OF CONSTRUCTION

ESWP 15 / ESWP22

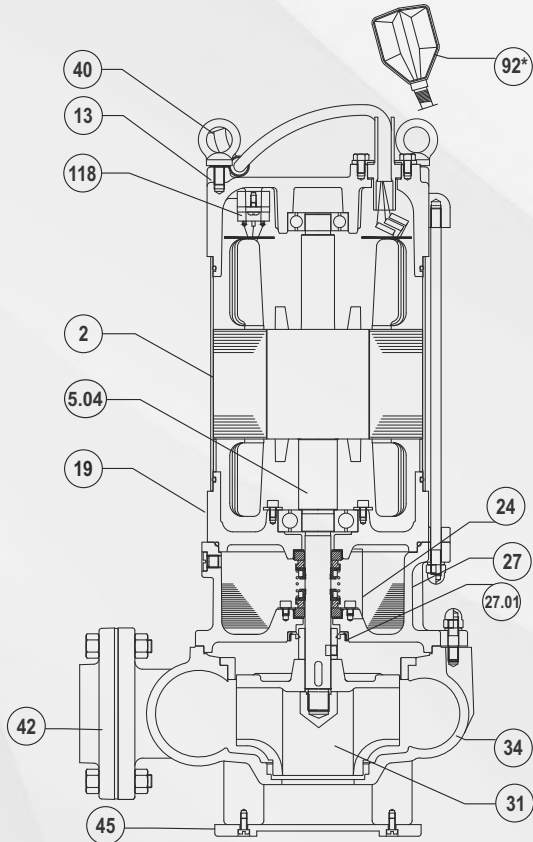

Part No.	Component	Material
2	Stator Body	SS, AISI 304
5.04	Motor Shaft	SS, AISI 410
13	Cable Cover	CI, FG 200
19	Bearing Housing	CI, FG 200
24	Mechanical Seal	Silicon vs Silicon ----- Carbon vs Ceramic
27	Oil Chamber	CI, FG 200
27.01	Lip Seal	SS + Nitrile Rubber
31	Impeller	CI, FG 200
34	Casing	CI, FG 200
40	Eye Bolt	CI, FG200
42	Delivery Flange	CI, FG 200
45	Casing Plate	CI, FG 200
92*	Float Switch	-
118	Thermal Overload Protector	-

* Float switch to be connected from Control Panel

DIMENSIONS AND WEIGHT

Pump Type	Power		Phase	Dimensions (in mm)			Solid Handling size mm	Weight kg
	HP	kW		A	B	øD		
ESWP03V	0.5	0.4	Single / Three	485	290	50	25	31.5
ESWP07V	1.0	0.75	Single / Three	505	290	50	25	32.5
ESWP11V	1.5	1.1	Single / Three	525	290	50	25	34

